

CONSTRUCTION

Foundation Drilling Cutting Tools



Foundation Drilling

At Kennametal, our commitment to your most demanding foundation drilling applications is unparalleled. We have a long history of helping you achieve success and a tradition of exceeding your expectations.

We remain focused on redefining and advancing the earthworks industries through our world-class solutions — delivered by professionals who are committed to the health and profitability of your enterprise.

MISSION Kennametal delivers productivity to customers seeking peak performance in demanding environments by providing innovative custom and standard wear-resistant solutions, enabled through our advanced materials sciences, application knowledge, and commitment to a sustainable environment.





Table of Contents

Quick Change	5-7
Wall Cutters	7-9
Welding Bars	10-16
Flat Tools	17
Modular Pilot Drills	17-19
Informational Icons Guide	19



The foundation for a successful drilling operation is built on rock-steady reliability and progress. Kennametal, the world's leading tooling and services provider, proudly introduces SOLID, our solution-focused platform that yields new levels of performance and productivity. SOLID-engineered tools deliver in the most challenging conditions. For unmatched quality, value, innovation, and application expertise, make Kennametal your SOLID choice.

Safety and Environment

Kennametal's goal of 100% safe extends far beyond our global operations to reach customers at their work sites, encouraging a community that values the implementation of safety procedures.

Kennametal ensures safety compliance by thoroughly testing and inspecting products and confirming that vehicles are appropriately equipped with safety equipment. Safety training is readily available to employees and customers alike. Whether in the office or at a customer's site, our employees drive a culture of 100% safe.



We protect our planet with a commitment to reduce the global impact Kennametal and our customers have on the environment — establishing effective sustainability practices and policies within the construction industry.

Helping customers meet their overall goals is clearly an objective of Kennametal's sustainability program. We focus on products that provide customers with lower fuel costs, reduced packaging requirements, lower transportation costs, and improved product performance. Kennametal continues to evaluate improved packaging materials — such as biodegradable options. By helping customers address their need to become more efficient, we make ourselves more sustainable.





KF Series • An Entirely New Platform for Foundation Drilling

Kennametal tools are the toughest, strongest, and longest lasting in the construction industry. Our cutting tools are renowned for their exceptional durability and wear resistance.

The foundation for a successful drilling operation is built on rock-solid reliability and progress. Kennametal, the world's leading tooling and services provider, proudly introduces a new platform of products — the KF Series. The KF Series covers the majority of core barrel applications.

Features and Benefits

Complete Portfolio and Offering

- NEW KF Series is complementary to existing portfolio of foundation drilling tools.
- Local technical support and inventory.

Superior Performance

- Ideal anywhere foundation drilling is being done, especially deep foundation of large diameter bore holes.
- Maintains Kennametal high standards of quality and performance and yields new levels of performance and productivity.

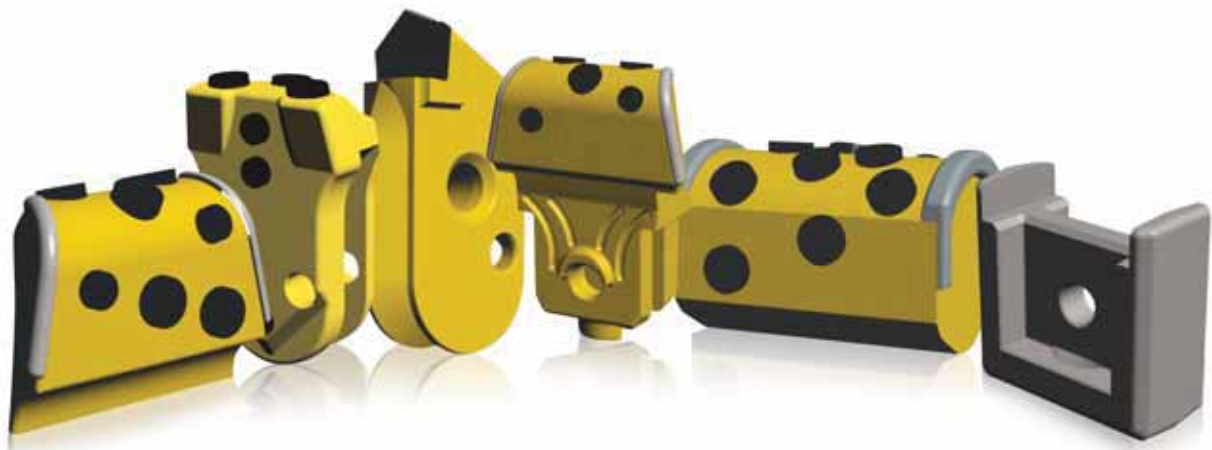

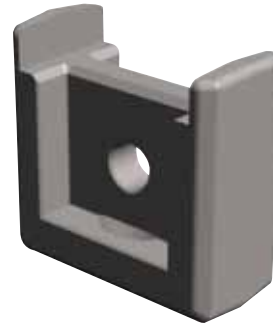
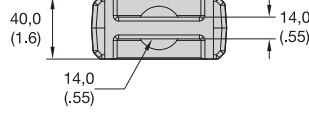
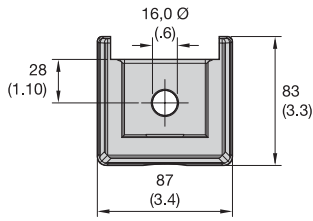

NEW!

■ KFQH408783NNU1

order number	catalog number
5379399	KFQH408783NNU1

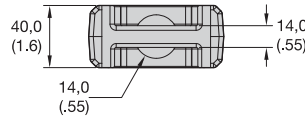
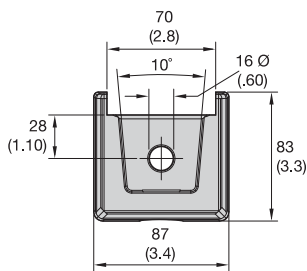

NEW!

■ KFQH408783NNUC

order number	catalog number
5379510	KFQH408783NNUC

■ Packaging Information

weight per piece		order number	catalog number	container type	pieces per container	container weight (approximate)	
kg	lbs					kg	lbs
1,18	2.60	5379399	KFQH408783NNU1	box	10	11,8	26.0
1,22	2.70	5379510	KFQH408783NNUC	box	10	12,2	27.0

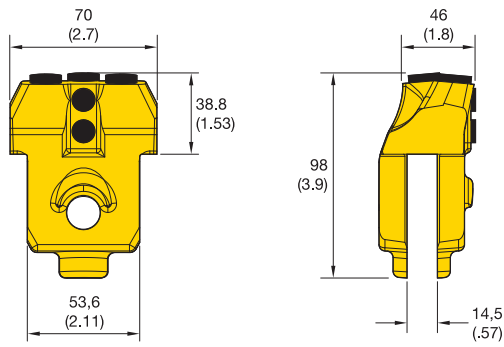

NEW!

■ **KFQT407085NNF1**

order number
5379511

catalog number
KFQT407085NNF1

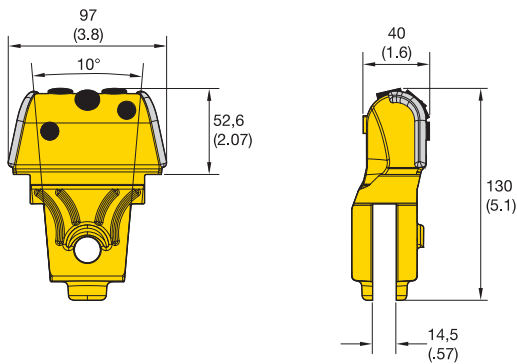

NEW!

■ **KFQT407085NNFC**

order number
5379512

catalog number
KFQT407085NNFC

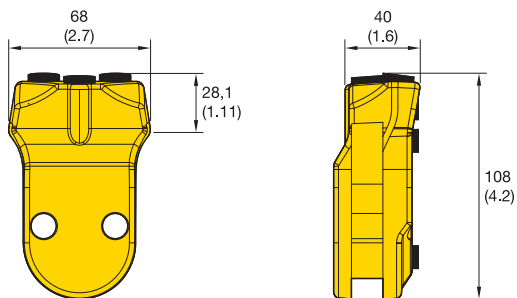

NEW!

■ **KFQT4070110NNF**

order number
5379513

catalog number
KFQT4070110NNF

■ Packaging Information

weight per piece		order number	catalog number	container type	pieces per container	container weight (approximate)	
kg	lbs					kg	lbs
1,17	2.58	5379511	KFQT407085NNF1	box	10	11,7	25.8
1,80	3.96	5379512	KFQT407085NNFC	box	10	18,0	39.6
1,30	2.87	5379513	KFQT4070110NNF	box	10	13,0	28.7

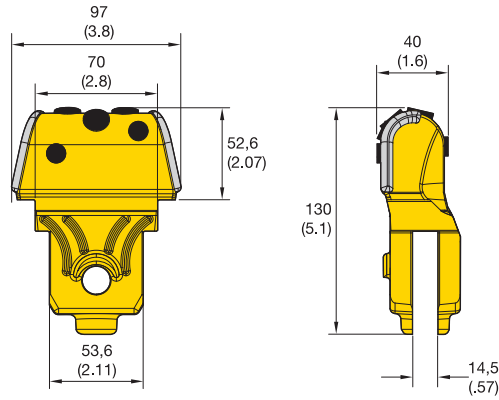

NEW!

■ KFQT4395130NNR

order number
5379514

catalog number
KFQT4395130NNR

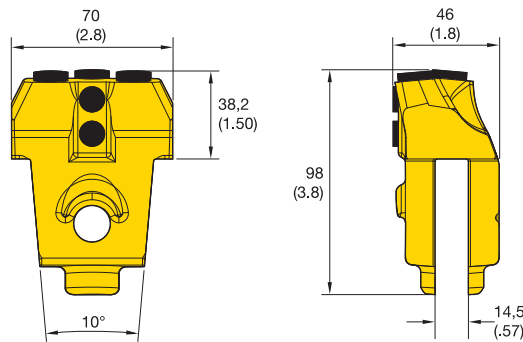

NEW!

■ KFQT4395130NNRC

order number
5379515

catalog number
KFQT4395130NNRC

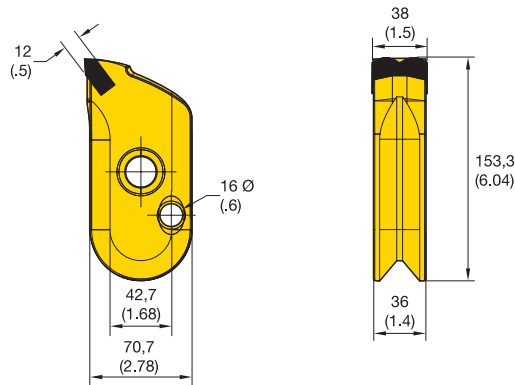

NEW!

■ KFWC3870153NNSD

order number
5379516

catalog number
KFWC3870153NNSD

■ Packaging Information

weight per piece		order number	catalog number	container type	pieces per container	container weight (approximate)	
kg	lbs					kg	lbs
1,13	2.50	5379514	KFQT4395130NNR	box	10	11,3	25.0
1,83	4.03	5379515	KFQT4395130NNRC	box	10	18,3	40.3
2,10	4.62	5379516	KFWC3870153NNSD	box	5	10,5	23.1

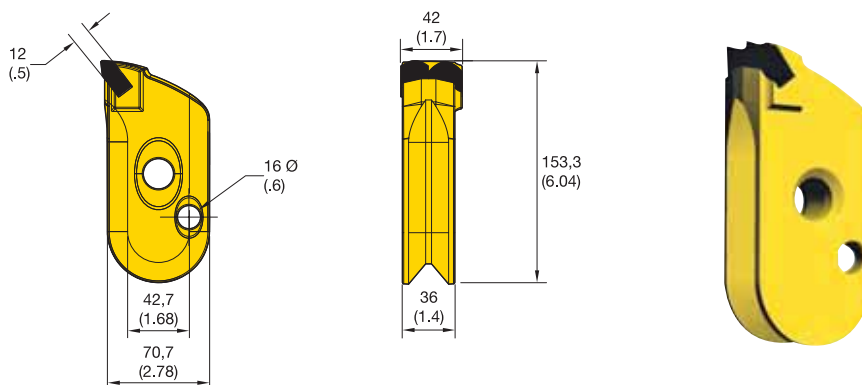

NEW!

■ KFWC4270153RNSD

order number	catalog number
5379517	KFWC4270153RNSD

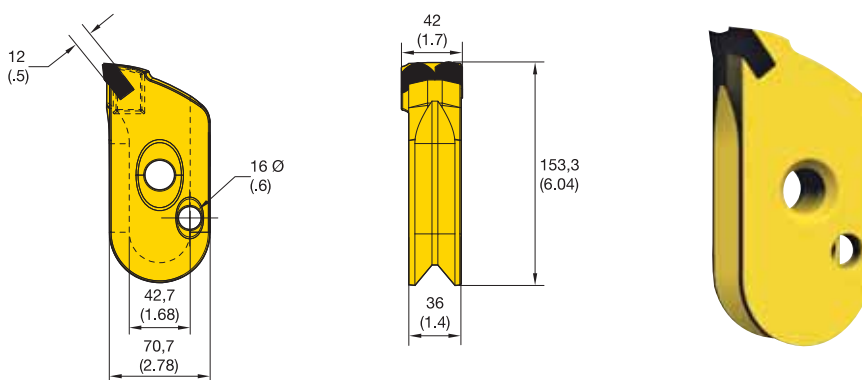

NEW!

■ KFWC4270153LNSD

order number	catalog number
5379518	KFWC4270153LNSD

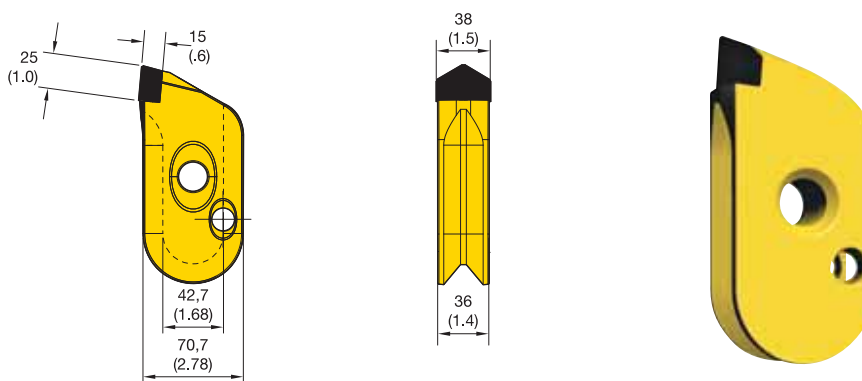

NEW!

■ KFWC3870153NNSS1

order number	catalog number
5379519	KFWC3870153NNSS1

■ Packaging Information

weight per piece		order number	catalog number	container type	pieces per container	container weight (approximate)	
kg	lbs					kg	lbs
2,12	4.67	5379517	KFWC4270153RNSD	box	5	10,6	23.4
2,12	4.67	5379518	KFWC4270153LNSD	box	5	10,6	23.4
2,01	4.43	5379519	KFWC3870153NNSS1	box	5	10,0	22.2

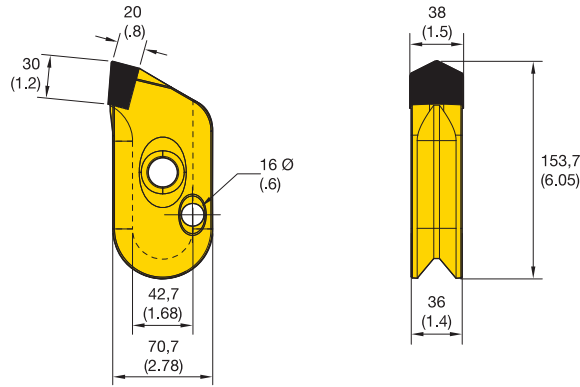

NEW!

KFWC3870153NNSS2

order number	catalog number
5379520	KFWC3870153NNSS2

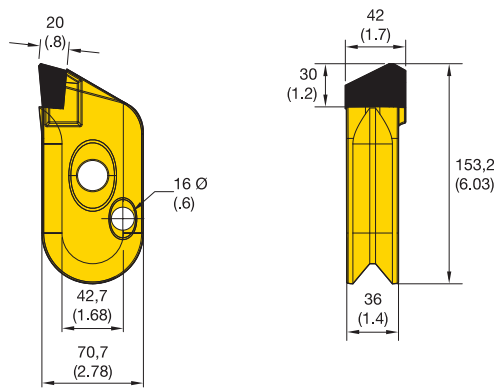

NEW!

KFWC4270153RNSS

order number	catalog number
5379521	KFWC4270153RNSS

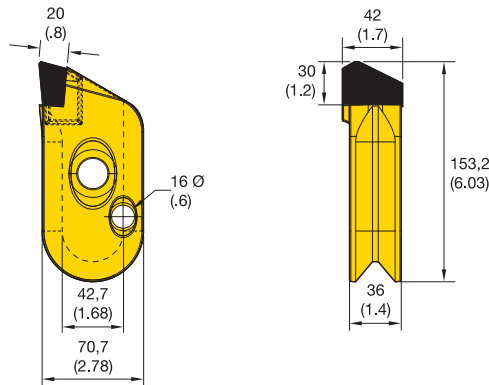

NEW!

KFWC4270153LNSS

order number	catalog number
5379522	KFWC4270153LNSS

Packaging Information

weight per piece		order number	catalog number	container type	pieces per container	container weight (approximate)	
kg	lbs					kg	lbs
2,05	4,52	5379520	KFWC3870153NNSS2	box	5	10,3	22,6
2,05	4,51	5379521	KFWC4270153RNSS	box	5	10,2	22,6
2,05	4,51	5379522	KFWC4270153LNSS	box	5	10,2	22,6

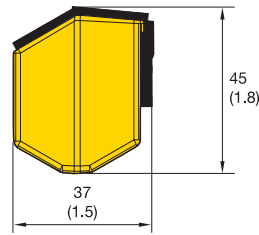
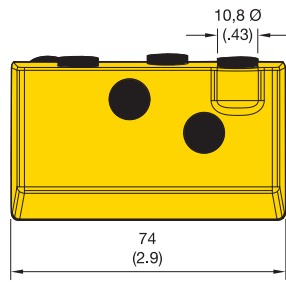

■ **KFWB377347NNF**

order number 5379523	catalog number KFWB377347NNF
--------------------------------	--

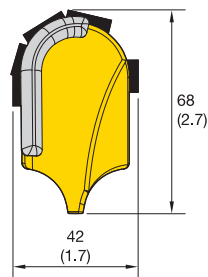
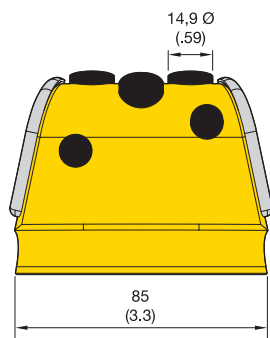

■ **KFWB429366NNR6**

order number 5379524	catalog number KFWB429366NNR6
--------------------------------	---

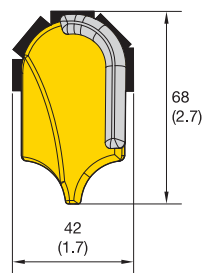
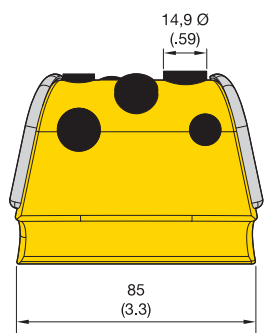

■ **KFWB429366NNR7**

order number 5379525	catalog number KFWB429366NNR7
--------------------------------	---

■ **Packaging Information**

weight per piece		order number	catalog number	container type	pieces per container	container weight (approximate)	
kg	lbs					kg	lbs
0,77	1.69	5379523	KFWB377347NNF	box	20	15,3	33.8
1,01	2.22	5379524	KFWB429366NNR6	box	15	15,1	33.3
1,03	2.26	5379525	KFWB429366NNR7	box	15	15,4	33.9

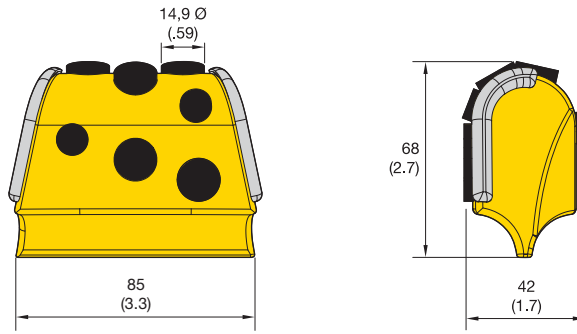
NEW!

KFWB429366NNR8

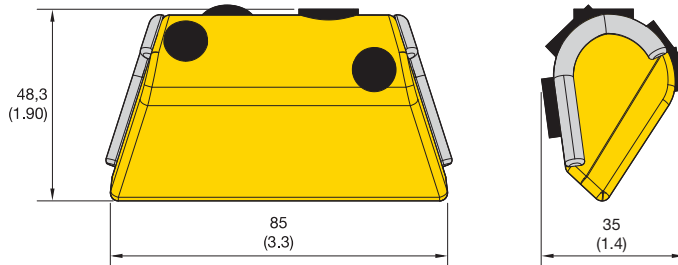
order number 5379526	catalog number KFWB429366NNR8
-------------------------	----------------------------------

NEW!

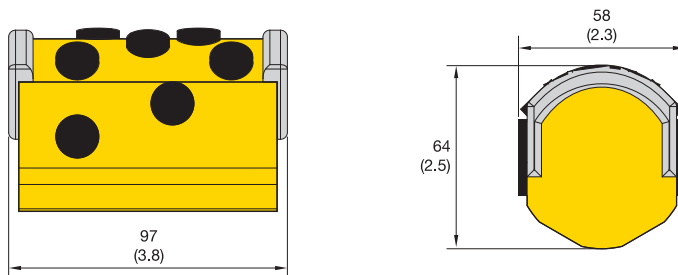
KFWB359048NNR

order number 5379527	catalog number KFWB359048NNR
-------------------------	---------------------------------

NEW!

KFWB589366NNR

order number 5379528	catalog number KFWB589366NNR
-------------------------	---------------------------------

Packaging Information

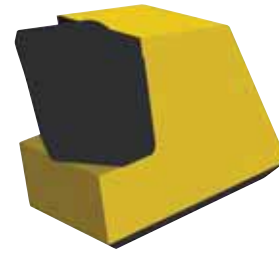
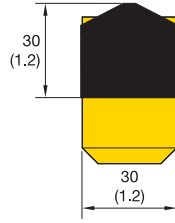
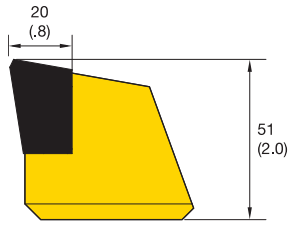
weight per piece		order number	catalog number	container type	pieces per container	container weight (approximate)	
kg	lbs					kg	lbs
1,05	2.31	5379526	KFWB429366NNR8	box	15	15,7	34.7
0,64	1.42	5379527	KFWB359048NNR	box	25	16,1	35.5
2,15	4.75	5379528	KFWB589366NNR	box	8	17,2	38.0



NEW!

■ KFWT316050NNS

order number 5379529	catalog number KFWT316050NNS
-------------------------	---------------------------------

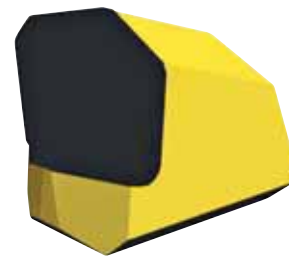
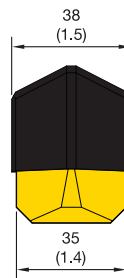
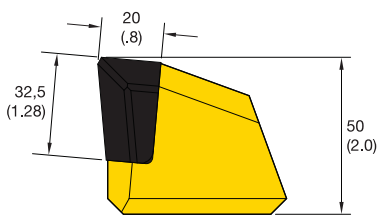

NEW!

■ KFWT386050NNS

order number 5379530	catalog number KFWT386050NNS
-------------------------	---------------------------------

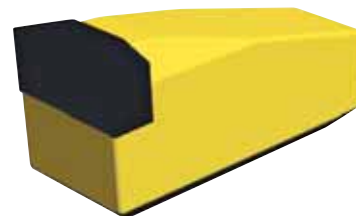
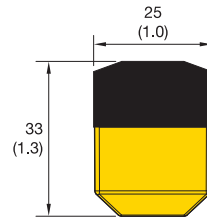
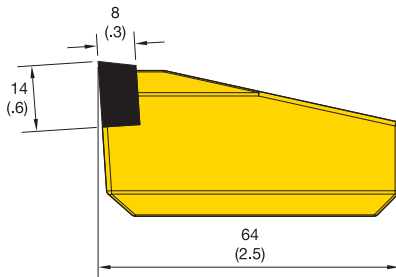

NEW!

■ KFWT256434NNF

order number 5379531	catalog number KFWT256434NNF
-------------------------	---------------------------------

■ Packaging Information

weight per piece		order number	catalog number	container type	pieces per container	container weight (approximate)	
kg	lbs					kg	lbs
0,56	1.24	5379529	KFWT316050NNS	box	15	8,4	18.6
0,65	1.43	5379530	KFWT386050NNS	box	15	9,7	21.5
0,29	0.63	5379531	KFWT256434NNF	box	50	14,3	31.6

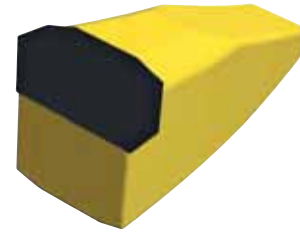
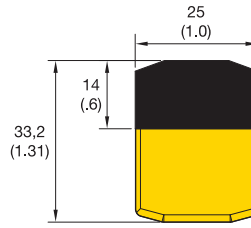
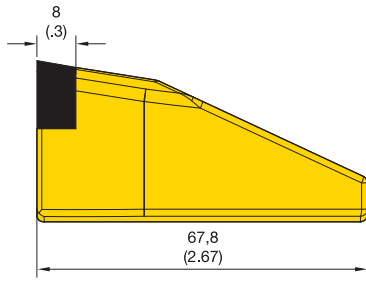
NEW!
KFWT25R34LNF

order number 5379532	catalog number KFWT25R34LNF
--------------------------------	---------------------------------------

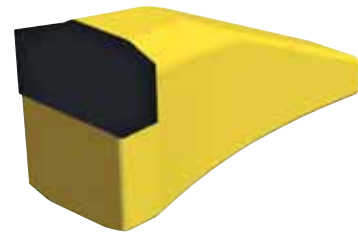
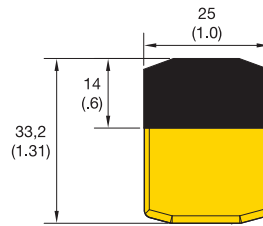
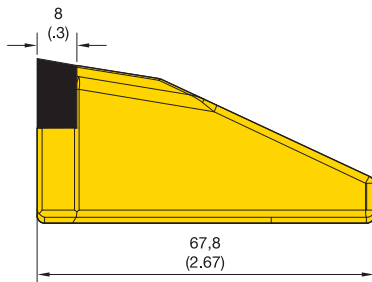
NEW!
KFWT25R34RNS

order number 5379533	catalog number KFWT25R34RNS
--------------------------------	---------------------------------------

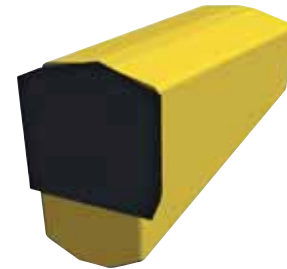
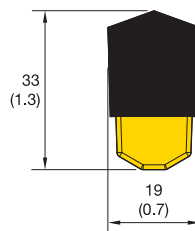
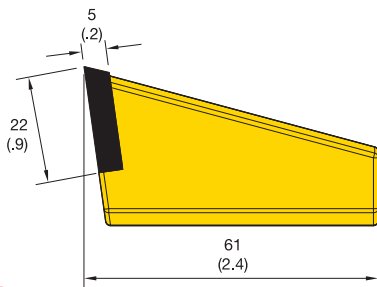
NEW!
KFWT196033NNF

order number 5379534	catalog number KFWT196033NNF
--------------------------------	--

Packaging Information

weight per piece		order number	catalog number	container type	pieces per container	container weight (approximate)	
kg	lbs					kg	lbs
0,26	0,58	5379532	KFWT25R34LNF	box	50	13,1	28,9
0,26	0,58	5379533	KFWT25R34RNS	box	50	13,1	28,9
0,16	0,36	5379534	KFWT196033NNF	box	50	8,1	17,8

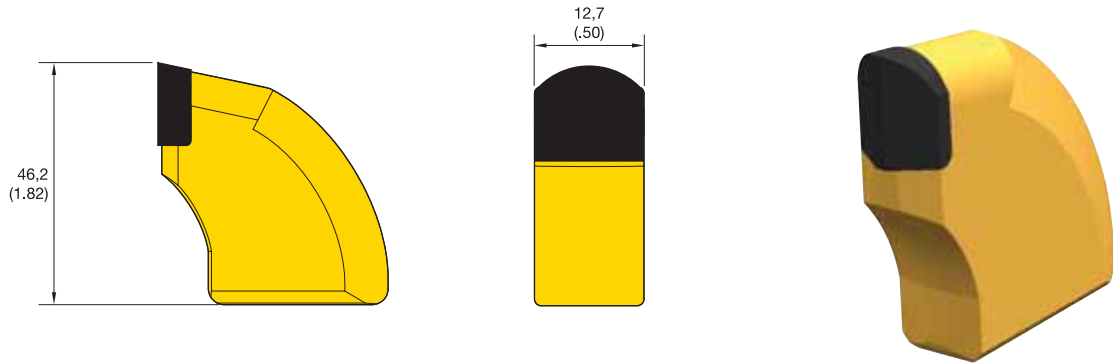

DT50

order number 1086101	catalog number DT50
--------------------------------	-------------------------------

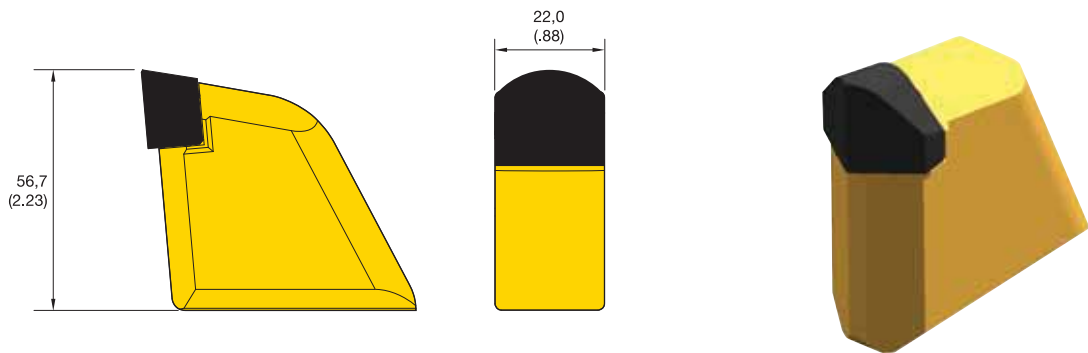

DT87

order number 1086378	catalog number DT87 TOOTH
--------------------------------	-------------------------------------

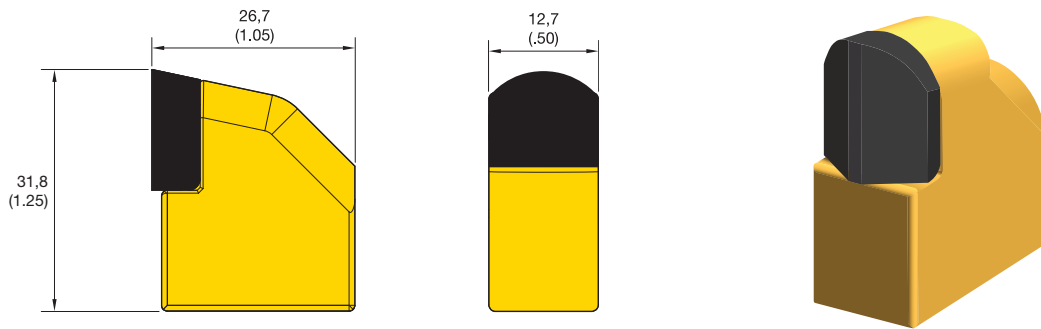

RT1

order number 1784646	catalog number RT1
--------------------------------	------------------------------

Packaging Information

weight per piece		order number	catalog number	container type	pieces per container	container weight (approximate)	
kg	lbs					kg	lbs
0,12	0,27	1086101	DT50	bucket	150	18,3	40,3
0,35	0,78	1086378	DT87 TOOTH	bucket	50	17,7	39,0
0,07	0,16	1784646	RT1	bucket	200	14,1	31,1

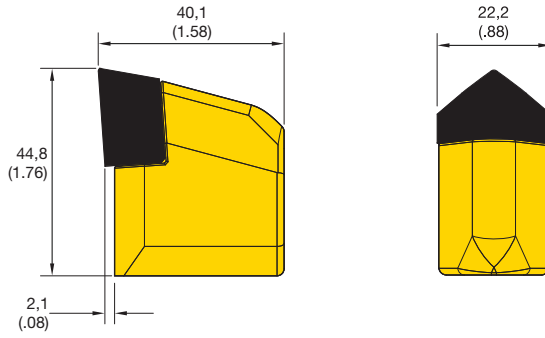

■ RT2

order number	catalog number
1844257	RT2

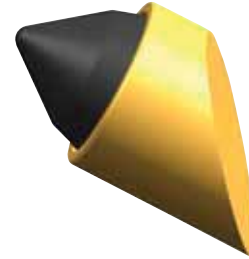
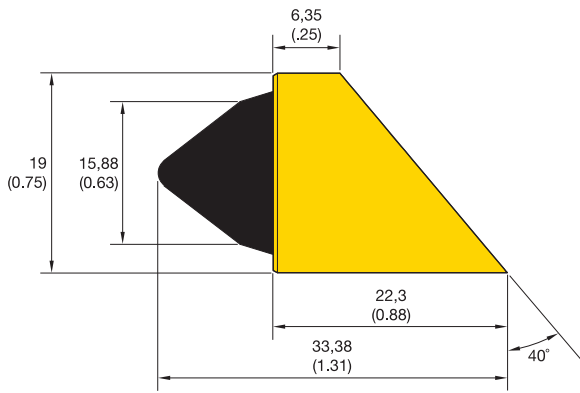

■ BR1

order number	catalog number
1800063	BR1

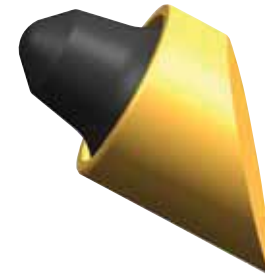
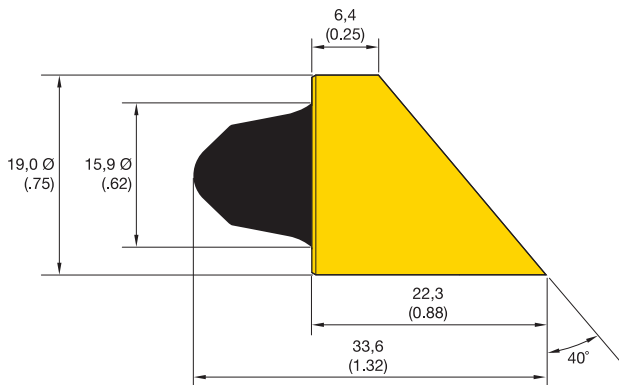

■ BR2

order number	catalog number
1858633	BR2

■ Packaging Information

weight per piece		order number	catalog number	container type	pieces per container	container weight (approximate)	
kg	lbs					kg	lbs
0,21	0.47	1844257	RT2	bucket	100	21,4	47.3
0,05	0.10	1800063	BR1	bucket	300	14,1	31.0
0,05	0.10	1858633	BR2	bucket	300	14,1	31.0

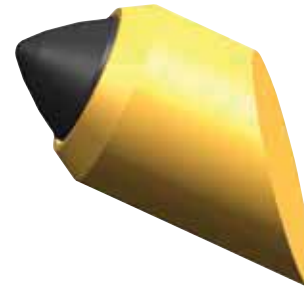
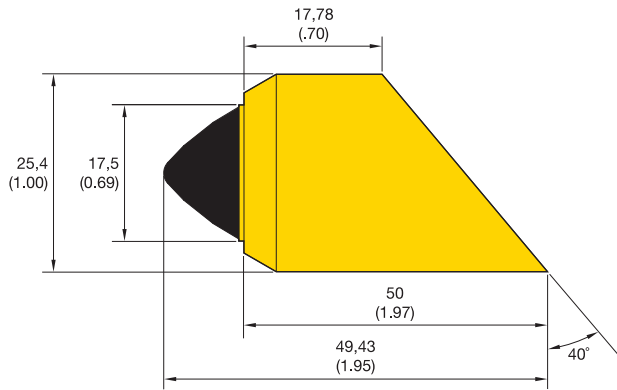

■ BR3

order number	catalog number
1858622	BR3

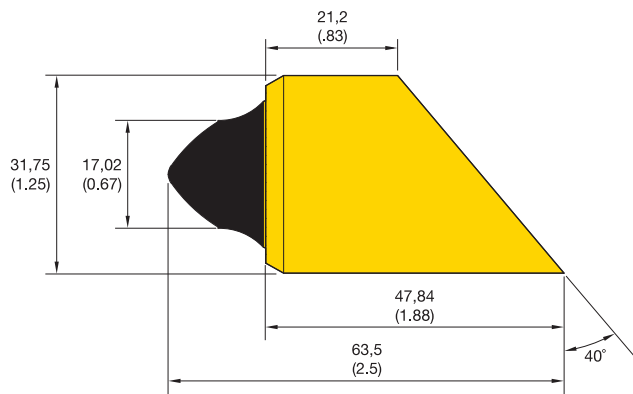

■ BR4

order number	catalog number
1858634	BR4

■ Packaging Information

weight per piece		order number	catalog number	container type	pieces per container	container weight (approximate)	
kg	lbs					kg	lbs
0,14	0,31	1858622	BR3	bucket	150	20,9	46,0
0,27	0,59	1858634	BR4	bucket	80	21,5	47,4

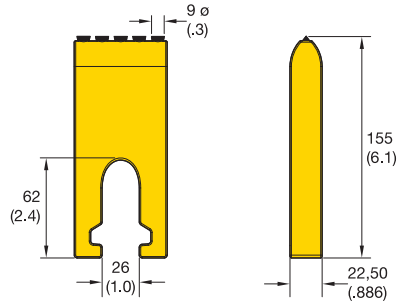
NEW!
KFFT2258155NNS

order number 5379397	catalog number KFFT2258155NNS
-------------------------	----------------------------------

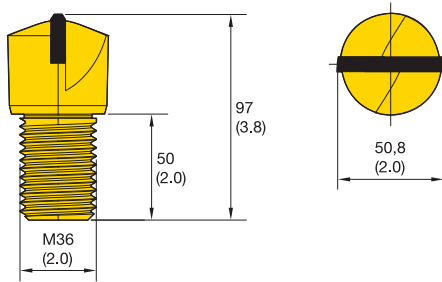
NEW!
KFPD5097RNM36

order number 5379398	catalog number KFPD5097RNM36
-------------------------	---------------------------------

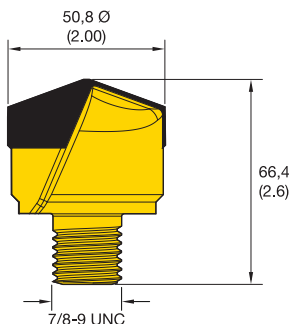
CP15 7/8-9 UNC

order number 1324059	catalog number CP15 7/8-9 UNC
-------------------------	----------------------------------

Packaging Information

weight per piece		order number	catalog number	container type	pieces per container	container weight (approximate)	
kg	lbs					kg	lbs
1,42	3.14	5379397	KFFT2258155NNS	box	10	14,2	31.4
0,87	1.91	5379398	KFPD5097RNM36	box	10	8,7	19.1
0,49	1.08	1324059	CP15 7/8-9 UNC	box	20	0,5	1.1

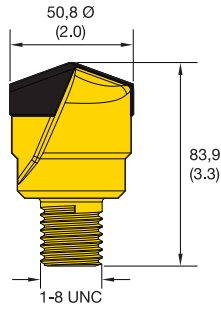

■ CP16 1-8 UNC

order number 1012300	catalog number CP16 1-8 UNC
--------------------------------	---------------------------------------

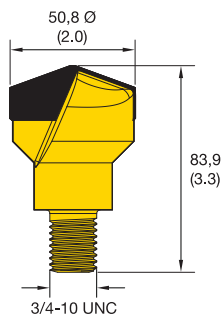

■ CP17 3/4-10 UNC

order number 1012301	catalog number CP17 3/4-10 UNC
--------------------------------	--

■ Packaging Information

weight per piece		order number	catalog number	container type	pieces per container	container weight (approximate)	
kg	lbs					kg	lbs
0,67	1.48	1012300	CP16 1-8 UNC	box	20	0,7	1.5
0,53	1.16	1012301	CP17 3/4-10 UNC	box	20	0,5	1.2

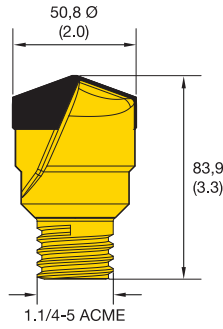

■ CP18 1.1/4-5 ACME

order number 1012304	catalog number CP18 1.1/4-5 ACME
--------------------------------	--

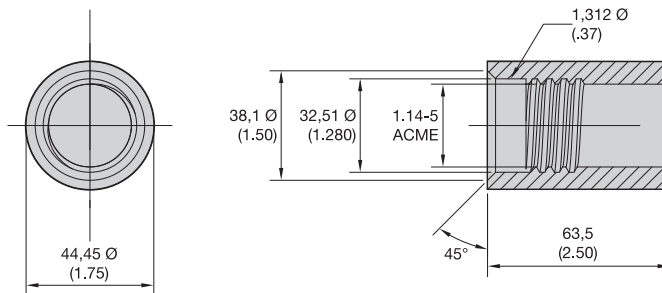

■ CP18 Holder

order number 1012287	catalog number CP18 HOLDER
--------------------------------	--------------------------------------

■ Packaging Information

weight per piece		order number	catalog number	container type	pieces per container	container weight (approximate)	
kg	lbs					kg	lbs
0,73	1.62	1012304	CP18 1.1/4-5 ACME	box	20	0,7	1.6
0,40	0.88	1012287	CP18 HOLDER	box	20	0,0	0.0

Informational Icons Guide



Insert Type:
Valve Seat



Insert Type:
Narrow Bottom
(NB)



Insert Type:
Cap

SAFETY NOTE

Kennametal has no control over the end use of its products or the environment into which those products are placed. Kennametal urges its customers to adhere to the recommended standards of use of their machines and tools and that they follow procedures that ensure safe operations.

The information included in this catalog and other recommendations on machining practices referred to herein are only advisory in nature and do not constitute representations or warranties and are not necessarily appropriate for any particular work environment or application.

Kennametal Inc. encourages the safe use of its products.

To help avoid personal injury or damage to tools, please follow these recommended guidelines:

- Wear approved personal protection equipment, including eye, ear, head, and foot protection.
- Make sure tools are properly seated and securely retained.
- Do not strike tools with metal objects. Carbide tips could shatter.
- Exercise care when removing tools.
- Inspect tools before each use. If they are dull, cracked, burred, or bent, do not use them.
- Operate all machines within the OEM parameters and with safety in mind. Stand clear of machines in use and make sure protective guards are in place.
- Do not change tools when the drum is moving or still engaged.





Argentina

Phone: 54.11.4719.0700

Fax: 54.11.4719.6116

Australia/New Zealand

Phone: 61.7.3801.5844

Fax: 61.7.3801.5826

k-sydn.service@kennametal.com

Brazil/Latin America

Phone: 55.19.3936.9200

Fax: 55.19.3936.9201

bra.marketing@kennametal.com

Chile

Phone: 56.2.2641177

Fax: 001.888.442.4964

China

Phone: 86.400.650.1388

Fax: 86.10.8561.5263

k-cn-earthwork.service@kennametal.com

Germany/European Served Area

Phone: 49.6172.737.498

Fax: 49.6172.737.42.453

mcs-ag.service@kennametal.com

India

Phone: 91.80.2839.4321

Phone: 91.80.2219.8444

Fax: 91.80.2839.1300

Japan

Phone: 81.3.3820.2855

Fax: 81.3.3820.2800

k-jp.service@kennametal.com

Korea

Phone: 82.2.2109.6100

Fax: 82.2.2109.6981

Malaysia

Phone: 6.03.5569.9080

Fax: 6.03.5569.0080

Poland/Slovakia/Baltics

Phone: 48.61.665.6520

Fax: 48.61.665.6521

zory.orders@kennametal.com

South Africa/Sub Saharan Area

Phone: 27.11397.3540

Fax: 27.11397.3222

Singapore/Vietnam/Philippines/Indonesia

Phone: 65.6265.9222

Fax: 65.6861.0922

k-sg.sales@kennametal.com

Thailand

Phone: 66.2642.3455

Fax: 66.2641.2736-8

United States/Canada/Mexico

Phone: 800.458.3608

Fax: 800.521.3319

mcs-na.service@kennametal.com

World and Corporate Headquarters

Kennametal Inc.
1600 Technology Way
Latrobe, PA 15650 USA
Phone: 800.446.7738 (United States and Canada)
E-mail: info@kennametal.com

European Headquarters

Kennametal Europe GmbH
Rheingoldstrasse 50
CH 8212 Neuhausen am Rheinfall
Switzerland
Phone: (41) 52.6750.100
E-mail: neuhausen.info@kennametal.com

Asia-Pacific Headquarters

Kennametal (Singapore) Pte. Ltd.
3A International Business Park
Unit #01-02/03/05, ICON@IBP
Singapore 609935
Phone: 65.6265.9222
E-mail: k-sg.sales@kennametal.com

India Headquarters

Kennametal India Limited
8/9th Mile, Tumkur Road
Bangalore - 560 073
Phone: +91 (80) 2839 4321
E-mail: bangalore.information@kennametal.com

